

A Model of Community Spirit

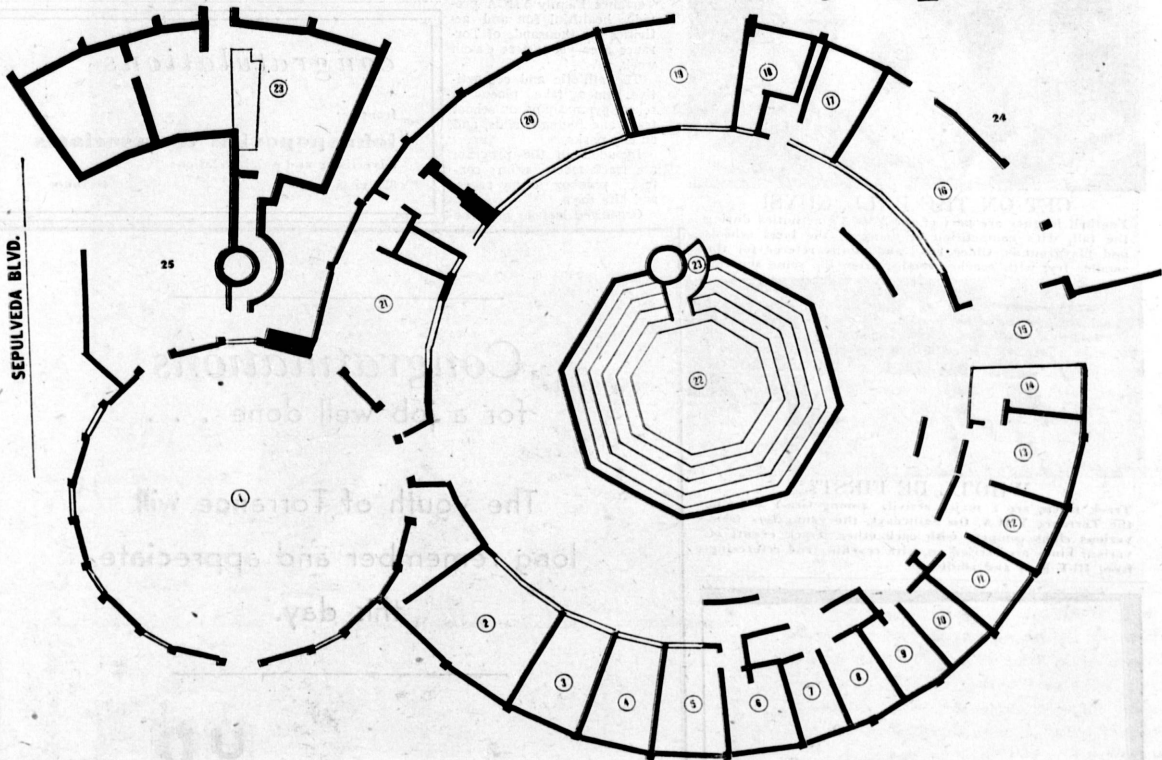

Community Backing Makes It Possible

A roster of community service is evident in the listing of donors who contributed funds for entire sections of the new YMCA facilities in Torrance. Following is a key to the room numbers in the floor plan shown above.

- | | |
|--|--|
| 1. Multi-Purpose Hall, with adjoining storage and sound rooms. | 13. General Business Office (Dr. and Mrs. Rollin R. Smith). |
| 2. Lions Club Craft Room. | 14. Reception Counter and Handicraft Display (Torrance Police Officers Association). |
| 3. Kiwanis Youth Club Room. | 15. Lobby and Entry (Torrance Junior Chamber of Commerce). |
| 4. Civitan Youth Club Room. | 16. Youth Game Room (Don Wilson and Riviera Hospital). |
| 5. Club Conference Room (Mr. and Mrs. M. Theodore Meier). | 17. Ladies' Restroom (South Bay Daily Breeze). |
| 6. Executive Office and Y-Indian Guides (South Torrance Lions). | 18. Mens' Restroom (Los Angeles Times Charities). |
| 7. High School Program Office (Jim Bower). | 19. Youth Club Lounge and Patio (Mr. and Mrs. H. Theodore Meier). |
| 8. Jr. Hi-Y Program Office (South Torrance Lions Club). | 20. Council Room, Chapel (Provided by Ray Watt). |
| 9. Gra-Y Club Program Office (Burton E. Belzer). | 21. Bezdeka Kitchen and Teen Kitchen (Union Carbide Corp.). |
| 10. Girls' Program Office (Las Vecinas Womans Club). | 22. Central Amphitheatre and Campfire Circle (Torrance Y's Men). |
| 11. Counseling Office (Clara Conner in memory of her husband). | 23. Mobil Oil Cave Club and adjoining Mechanical Rooms (inset). |
| 12. Leader Aid Room — Printing 250,000 pieces of mail per year (Torrance Education Association). | 24. Youth Game Patio, (Harvey Aluminum). |
| | 25. Service Yard. |

The New YMCA Floor Plan

The floor plan of the completed first phase of the Torrance family YMCA makes ample use of the California outdoors with its amphitheater and campfire circle in the open central patio. The plan above shows the general purpose auditorium and the club and craft rooms which surround the amphitheater. Upper left is the detail of the Cave Club Room which can be entered off the Campfire Circle or from the service area.

Congratulations

to the new Torrance

Y. M. C. A.

a proud addition to a
growing community

the Broadway

IN THE DEL AMO SHOPPING CENTER
HAWTHORNE AT CARSON, TORRANCE
FR 1-4681