

# TORRANCE IS GROWING UP!

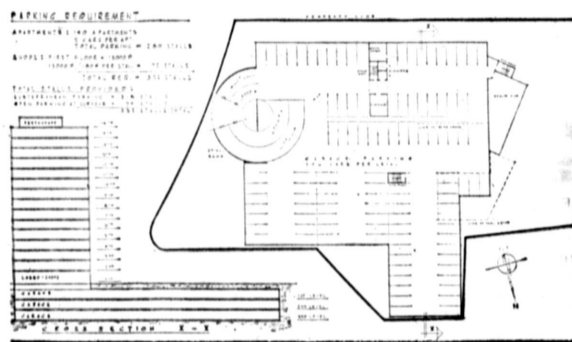

## PRECISE PLAN SOVEREIGN RIVIERA TOWER

Property improvements as submitted to the City of Torrance for approval. Approval would apply to THIS Plan for THIS PROPERTY ONLY and is not transferable to another owner. The improvements would comply with details of the Plan.

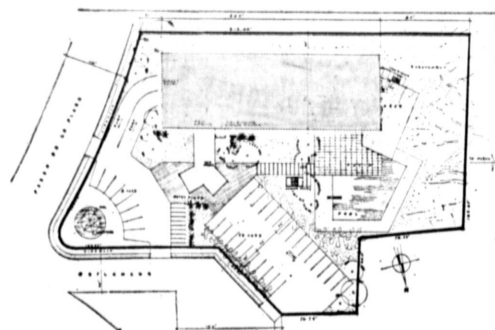

**PROJECT FOR**  
**Sovereign Development Co.**  
 205 PASEO DE LA PLAYA, TORRANCE, CALIF.

**EARDLEY, BURCHFIELD & ASSOCIATES**  
 Architects and Engineers  
 John K. Eardley, Consulting Engineer RCE 13474  
 William Burchfield, A.I.A., Architect C 2457  
 1629 Cranshaw Blvd., Torrance, California

The design of this project will be essentially as shown on this map, but authority is reserved to make slight changes in details of building arrangements, parking dimensions, parking facilities; provided, however, no increase in the proportions shall be permitted and further provided:

A. There shall be no decrease in the car capacity of parking facilities.  
 B. The points of ingress and egress onto adjacent streets shall remain essentially as indicated on map.  
 C. Service facilities to each building shall be provided in essentially the same manner as indicated on map.

## PROPOSED \$6 MILLION CONDOMINIUM APARTMENT BUILDING FOR TORRANCE BEACH . . .

- 140 one, two and three bedroom luxury apartments . . . all with a view
- 17% land coverage leaving 83% for landscaping, swimming pool, sculptured fountain and other exterior beautifications
- Unique landmark for citing the progressiveness of Torrance
- ADULT LEISURE LIVING . . . no children under 16 years
- Unique top floor restaurant and banquet room to be reached by an outside, glass-enclosed elevator
- Three stories of subterranean garages, plus surface parking exceeding all requirements of the city zoning ordinances

**This building will provide an estimated \$129,663.00 annually in real estate tax revenue to the area\* . . . will minimize obstruction of views of residents in the area and will be the criterion to upgrade standards for future development.**

## JOIN THE FOLLOWING PEOPLE AND MANY OTHERS IN SUPPORTING THE ZONE CHANGE TO PERMIT THIS BUILDING TO BE BUILT . . . CALL YOUR COUNCILMEN . . . ATTEND CITY COUNCIL MEETING AUG. 11th . . . AND SPEAK UP.

### SURROUNDING AREA RESIDENTS

Mr. and Mrs. C. C. Adams  
 Adams, Latham, Kripp & Wright, A.I.A.  
 Mr. H. P. Bagley  
 Mr. I. Baller  
 Mr. Frank Colombo  
 Mr. Richard B. Collins, Atty.  
 Mr. and Mrs. William H. Constable  
 Mr. John Crene  
 Corwin H. Eberling Jr. A.I.A.  
 Mr. and Mrs. William von Eckartsberg  
 Mr. and Mrs. Henry Eiszler  
 Mr. and Mrs. Sam Gilpatrick  
 Mr. and Mrs. W. G. Hammack  
 Mr. Richard L. Herbert  
 Mrs. Rachel Hirschfeld  
 Mr. Weldon S. Johnson  
 Mr. and Mrs. William P. Johnson  
 Mr. Frank Keavy  
 Mrs. Toby Keebler  
 Mrs. La Anita Landre  
 Mr. and Mrs. Bill McLaughlin  
 Mr. Walter Mound  
 Mr. and Mrs. Ronald E. Moran  
 Mrs. Pauline A. Morrell  
 Mr. and Mrs. Jack M. Nichols  
 Mr. and Mrs. Paul Pierson  
 Mr. R. L. Riboh  
 Mr. and Mrs. Jacob Rosenkrantz  
 Mr. and Mrs. H. A. Schmid  
 Mr. John O. Schmidt  
 Mr. and Mrs. Arthur P. Thain  
 Mrs. Ida Allison  
 Mr. and Mrs. Gerald L. Alter  
 Alter Realty  
 Mr. Donald Avey  
 Dr. and Mrs. John W. Beeman  
 Mr. Robert A. Beersch

### TORRANCE RESIDENTS

Mr. and Mrs. Ellis D. Blankenship  
 Mr. Walter E. Boden, Sr.  
 Mr. and Mrs. Richard Bonham  
 Mr. and Mrs. V.P. Bordeau  
 Mrs. Peggy R. Brotman  
 Mr. Parke E. Bryan  
 Mr. and Mrs. David Buhai  
 Mr. Wm. Burchfield, A.I.A. and Assoc.  
 Mr. and Mrs. Frank W. Burk  
 Mr. and Mrs. James F. Casey  
 Mrs. Jean Clawson  
 Mr. Ronald C. Clements  
 Mr. Harry Kaye  
 Mr. and Mrs. Kyle C. Custer  
 Denn Engineers  
 Mr. George W. Leseman Company  
 Mr. and Mrs. David Dunning  
 John K. Eardley & Associates  
 Mr. and Mrs. Nat E. Ellis  
 Mrs. George M. Faris  
 Mr. W. A. Felker  
 Mr. and Mrs. Robert M. Fox  
 Mr. and Mrs. Y. Frandsen  
 Mr. and Mrs. E. S. (Ted) Frenger  
 W. F. Robinson, Photography  
 Mr. Nathan A. Friedman  
 Mr. Henry A. Ross, P.E.  
 Mrs. L. M. Garritsen  
 Mr. Ray Griff  
 Mr. Dell Wright  
 Mr. and Mrs. Albert Hase  
 Frontier Realty Co.

Mr. George Heaton  
 Dr. A. C. Henggan  
 Mr. and Mrs. E. J. Holt  
 Mr. and Mrs. James Howlett  
 Mr. James W. Hurt  
 Mr. and Mrs. Robert R. Inslay  
 Mr. and Mrs. Leslie L. Jackson  
 Mr. M. Jellen & Del Amo Furniture Co.  
 Mr. Guy S. Johnson  
 Mr. and Mrs. B. T. Kenney  
 Mr. and Mrs. James E. Kenney  
 Mr. and Mrs. Louis M. Kochman  
 Dr. Herschel S. Kopp  
 Mr. H. F. Lindborg  
 Mr. James Mabes, C.P.A.  
 Mrs. James M. Manning  
 Mr. Louis Oltanian  
 Mr. and Mrs. Ed Opfergelt  
 Mr. and Mrs. William O'Reilly  
 Palo Del Amo Homeowners Association Bd. of Director  
 Mr. Keith A. Pischel  
 Mr. Joseph Price  
 Mr. and Mrs. Andrew Rees  
 Mr. and Mrs. Lee Renfroe  
 Mr. and Mrs. W. D. Remington  
 Mr. Robert Richardson  
 Mr. and Mrs. M. C. L. Ruiterman  
 Mr. Nello F. Scatena  
 Mr. and Mrs. Frank D. Sciarrotta

Mr. Donald J. Silva  
 Chester C. Smith, A.I.A. and Associates  
 Mr. Edward F. Stagsdell  
 Mr. Clarence F. Sweet  
 Mr. and Mrs. David Tanner  
 Torrance Exchange Club  
 Torrance-Lomita Board of Realtors Bd. of Director  
 Mr. and Mrs. D. A. Van Horn  
 Mr. and Mrs. Robert Vroman  
 Dr. and Mrs. James F. White  
 Mr. and Mrs. Paul J. Wilde  
 Mr. and Mrs. Richard I. Wilson  
 Mr. George S. Wing  
 Mr. Wayne Woodman

★ ★ ★

*CITY OF TORRANCE	@ 1,238	PER \$100	\$18,570.00
Los Angeles County	@ 2,0818	" "	31,227.00
TORRANCE SCHOOLS	@ 4,0306	" "	60,459.00
EL CAMINO COLLEGE	@ .5730	" "	8,595.00
L. A. Flood Control	) @ .7208	" "	10,812.00
Sanitation District			
Water			
Metro. Water Dist.			
			\$129,663.00