

## Reasons Behind New Probation at College Told

Reasons behind the action of El Camino College's establishment of a new probationary system were explained by Dr. Stuart E. Marsee Monday evening in a network radio broadcast conducted by George Walsh of the "This is Los Angeles" program.

Adopted at the Feb. 8 meeting of the college Board of Trustees, the new probationary plan will go into effect in September. Dr. Marsee indicated in the interview that measures taken by the college have been taken, not to reduce enrollment, but to upgrade scholastic achievement of college students.

"We feel that local taxpayers in California should not expend \$550 to \$600 a year for the education of pupils who are not achieving in our school," the college president told Walsh.

Use classified Call FA 8-2345

## Socony Invents Language to Instruct Electronic Brain

Socony Mobil, which pioneered in the use of electronic computers for making refineries more efficient, has invented a new time-and-money-saving language for talking to the high-powered calculating machines. Dallas R. Lamont, the company's director and vice president for research, said the new language may cut one major cost of computer operation by as much as 80%.

The new language, called PROLAN (PROcess LANGUAGE) is like basic English or Esperanto. It uses the specialized vocabulary of refinery engineers. The new language enables these engineers, who ordinarily would need a long training period to work directly with a computer, to give a problem to the computer after only a few days' training.

With PROLAN, the engineer can describe to a computer in his own engineering language a new processing setup or new refinery. The computer, in turn, performs a vast amount of trans-

lation drudgery, converting PROLAN into language that can be stored on tape and used for various computations. Such computations can, for example, tell the refinery technologist about the performance and operating costs of the new refinery he described in PROLAN.

Hicks pointed out a programmer may need months to give a set of instructions to a computer. The complex chores of housekeeping (making sure that the instructions are orderly) and debugging (checking for and eliminating errors in the instructions) have caused some experts, Hicks said, to estimate the cost of programming a computer at \$1 to \$4 a command.

PROLAN comes in particularly handy when an engineer, who has an idea for a way to transform petroleum into a new product, wants to ask a computer how his refinery setup will work out if it is built into one of the company's refineries.

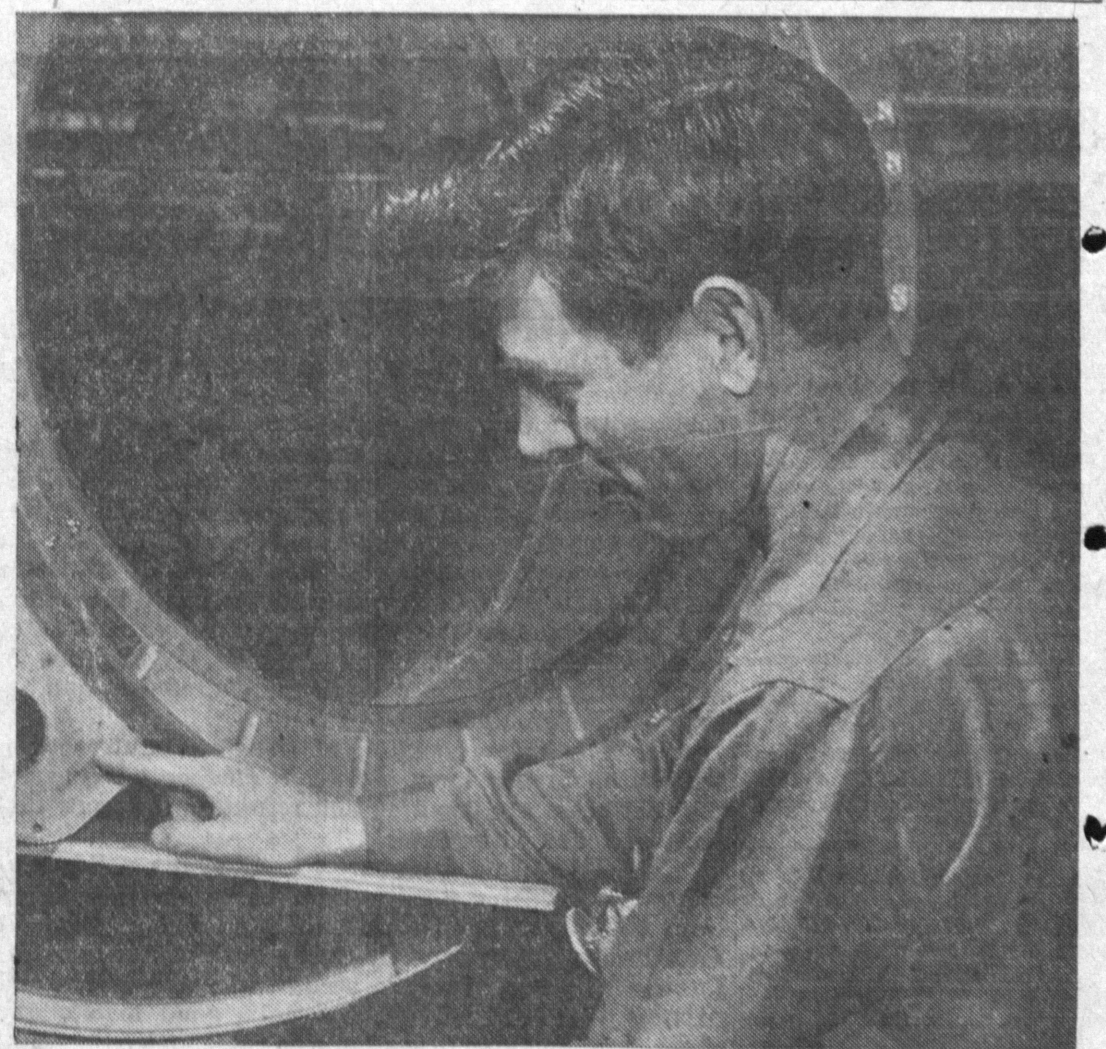

WINNER—James Dorman, 20819 S. Normandie Ave., shows brace for engine cowl that won him \$180 in employees' suggestion program at North American Aviation missile division in Downey.

### DENTAL PLATES

REPAIRED AND RELINED WHILE-U-WAIT

#### GAS OR PENTATHOL

FOR EXTRACTIONS AT THE SAME PRICE

COMPLETE DENTAL SERVICE  
• X-ray • Partials • Fillings • Pyorrhea Treatment  
OPEN EVENINGS AND SATURDAY—NO APPOINTMENT NECESSARY

Member of the American Academy of Dental Surgeons, also member of the California Society of Dental Surgeons.  
Modern Ground Floor Offices with ample parking and air conditioning for your convenience.

2418 TORRANCE BLVD., NEAR CRENSHAW • GROUND FLOOR

18 MONTHS TO PAY  
• FIRST PAYMENT MARCH, 1960

DIFFICULT CASES WELCOMED  
• PENSIONERS WELCOMED

SE HABLA ESPANOL

### DR. TARR

CREDIT DENTIST

FA 8-0250  
For Low Prices

# Free Bus Rides!★ to Downtown Torrance During Dollar Days

THURSDAY, FRIDAY AND SATURDAY, FEBRUARY 18, 19 AND 20

\*Through the courtesy of the Torrance City Council, the Torrance Municipal Bus Lines are permitting free bus rides on any of their buses (to Torrance only) between the hours of 10 a.m. and 4 p.m.

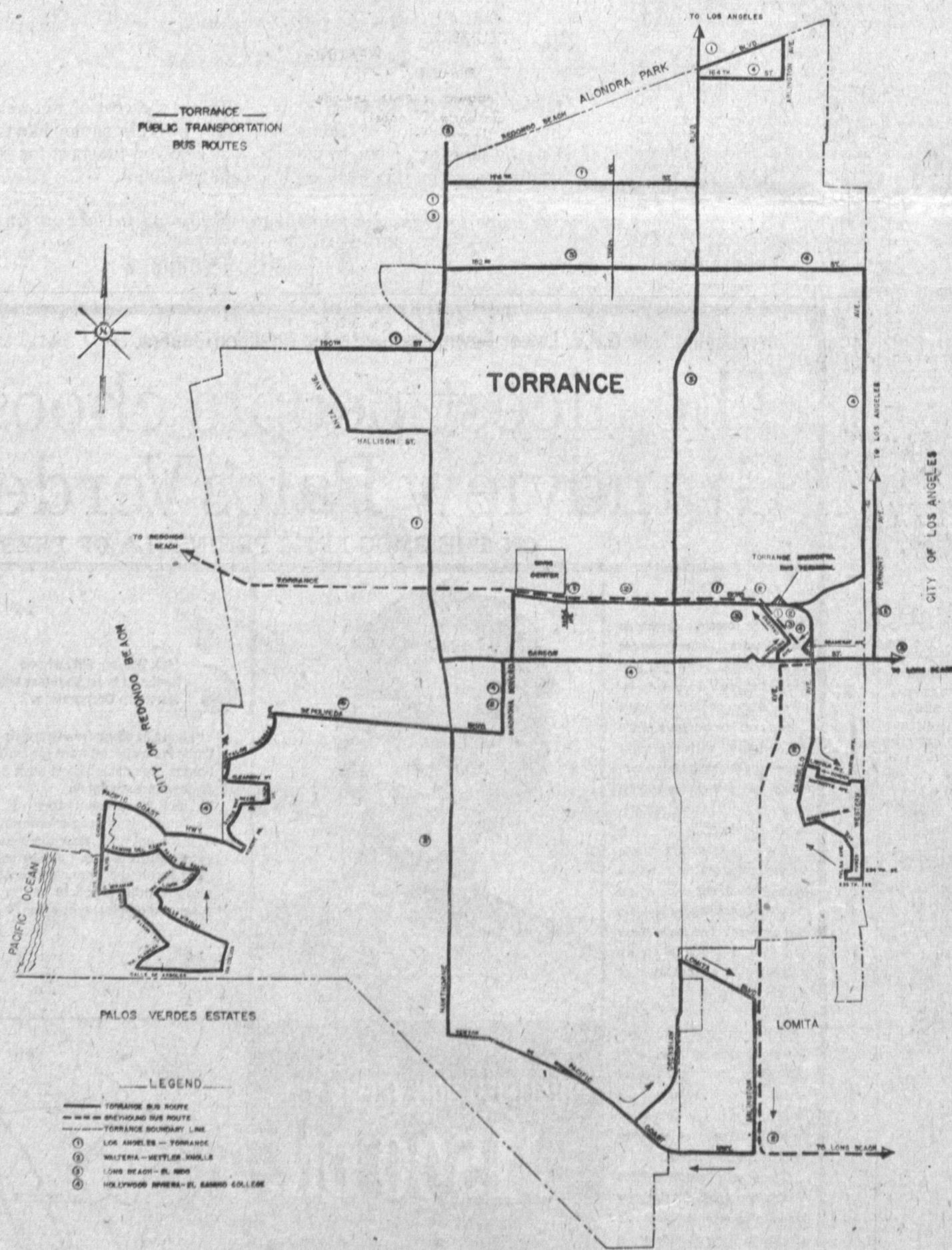

**RIDE THE BUS . . . NO PARKING FUSS  
ON AT YOUR DOOR . . .  
OFF AT YOUR STORE!**

This Advertisement Sponsored by Downtown Torrance Retail Merchants

## Auto Fatalities Down in 1959

Fatal accidents on Los Angeles County freeways were reduced by more than nine percent during 1959 as compared with 1958, and deaths were down more than 8 percent, the Automobile Club of Southern California revealed today.

Freeway fatalities during 1959 totaled 78, suffered in 65 accidents. During 1958 there were 81 deaths in 70 accidents. About 16 miles of freeway were added to the system last year.

Of the 1959 fatal accidents, 33 occurred within Los Angeles City, and caused the deaths of 35 persons.

Five of the fatalities in the county were pedestrians, all male. The 20 to 30 year-old male group accounted for the greatest number of deaths, with 21 fatalities recorded. Next highest was the 30 to 40 male group, with 16.

March, with 13 deaths, proved to be the most dangerous month, followed closely by November, when 12 fatalities occurred as the result of freeway accidents. Sunday topped the list of days, with 24 persons killed, and the hour between 2 and 3 a.m. proved fatal for 12 freeway travelers.

## Gas Heating Goes into 99% of New Homes

All the advantages included in scientifically engineered gas heating systems—economy, convenience, and comfort—are among the construction ingredients in Great Builders Series homes that are answering some of the Southland's home-buying public.

According to Carl W. Shupp, division manager for the Southern California Gas Co. here, gas heating equipment developed in recent years has boosted use of gas for heating to a total of more than 99% of the new homes being built in the Southland. In addition, Shupp explained, the units offer low-cost installation, as well as low maintenance and fuel expenses, adequate sizing and design for comfort, and completely automatic controls for ease of operation.

Modern gas heating units on the market today range from wall heaters and floor furnaces, and gravity warm-air system, to the forced-air furnace and the perimeter and radiant methods that are meeting even greater needs of the building industry.

## Drain Bonds on Market

The Board of Supervisors today authorized the sale of 1958 storm-drain bonds for \$10,000,000 to finance the county's storm-drain program through the fall of 1960.

## LEGAL NOTICES

**CERTIFICATE OF BUSINESS**  
FICTITIOUS FIRM NAME  
THE UNDERSIGNED does hereby certify that he is conducting a Gardening Maintenance and Parking Lot Sweeping business at 3118 Torrance Boulevard, City of Torrance, County of Los Angeles, State of California, under the fictitious firm name of RON'S LANDSCAPING GARDENING and that said firm is composed of the following persons, whose names and addresses are as follows, to-wit:  
Ronald Power, 3544 Garnet Street, Torrance, California.  
WITNESS his hand this 16th day of February, 1960.

STATE OF CALIFORNIA,  
COUNTY OF LOS ANGELES—ss  
ON THIS 16th day of February A.D., 1960, before me RUTH H. PETERSON a Notary Public in and for said County and State, residing therein duly commissioned and sworn, personally appeared Ronald Power, known to me to be the person whose name is subscribed to the within instrument, and acknowledged to me that he executed the same.  
IN WITNESS WHEREOF, I have hereunto set my hand and affixed my official seal the day and year in this certificate first above written.

(SEAL)  
RUTH H. PETERSON  
Notary Public in and for said County and State, My Commission Expires June 6, 1961.  
7-Feb. 16, 55, March 3, 19, 1960

DOLLAR DAY  
**SPECIAL**  
Thursday—Friday—Saturday  
COSTUME  
**JEWELRY**  
VALUES TO 3.95

**59¢** Each  
2 for 1.00

*Lawson's*  
JEWELERS

1317 El Prado Ave., Torrance FA 8-4313

DOLLAR DAY  
**SPECIALS!**

Famous Imported  
MAJA from Spain **\$1.00**

**SOAP**  
AND YOU RECEIVE **FREE**  
2 Bottles of Toilet Water  
—Imported from Spain. Hurry! Hurry! It was a complete sell-out last time we made this offer

Carver  
Mis-s-s-s-t-i-f-i-er **\$2.00**  
**Cologne**  
with famous spray-top bottle

Regular 2.50  
**BEAUTY FOAM** **\$1.00**  
by de Heriot. Borated moisturizing lotion

Mary Chess  
**Cream Body Massage** **\$1.50**  
Reg. \$3.00

*Ruth Davis*

1331 EL PRADO AVE.  
DOWNTOWN TORRANCE PHONE FA 8-4755  
Free 2-Hour Parking in Rear of Store