

### National Guard Openings Now Available Here

Lt. Col. William L. Geissert, commanding officer, 132nd Armored Engineer Battalion, California National Guard, announces that there are an unlimited number of openings for enlistment in the 6 months active duty program until further notice.

This program is available for young men who have not had any prior active service and have not been called for induction by their local selective service board. Age requirements are between 17-35 and must be able to pass a physical examination.

Any individual interested in information regarding this program should contact the Torrance National Guard Armory located at 2505 Cabrillo Ave.

### Wife Jailed in Abortion Investigation

Investigation into an alleged abortion ring broadened this week as the wife of a Burbank beautician was taken into custody.

Mrs. Blitz Santee, 26, was arrested Sunday when she came to the Torrance police station to visit her husband, Clarence Eugene, 47, nabbed Friday night.

Both were freed on \$1500 writs each, returnable today in Superior Court.

Det. Sgt. Don Hamilton said that Mrs. Santee was linked to illegal operations uncovered by investigators since her husband was taken into custody.

Santee was nabbed Friday night shortly after he allegedly performed an illegal operation on a 28-year-old Torrance housewife in her home.

Detectives have withheld the name of the woman. She assertedly paid \$300 for the surgery.

Meanwhile investigators have linked Santee and his wife with an operation in Downey a month ago, and another one in Manhattan Beach last February.

Detectives captured Santee after they staked out on the Torrance home after they had received a tip the surgery was to be performed there.



**BREAK GROUND**—Turning the first shovel of earth with gold-plated ceremonial shovels for the new Kentile, Inc., plant in Torrance are (from left) Fred Mill, president of the Chamber of Commerce; David Kennedy, president of Kentile; Mayor Albert Ison, and Joseph L. Kolsky, vice-president in charge of manufacturing for the firm. Kentile officials said that they expect to move machinery into the building by next January. —Press Photo

### Business Optimism Voiced at Kentile Groundbreaking

A healthy prosperity note-backed by business-warming statistics—was sounded Monday by a leading Eastern industrialist at ground-breaking ceremonies for construction of what will be one of the largest resilient tile flooring plants in the country.

David O'D. Kennedy, president of Kentile, Inc., here to officiate at ceremonies marking the start of an 18-acre Kentile manufacturing plant to service Western states, said that his company's sales for the first quarter of the year were up 11.5 per cent over the same period a year ago.

Then he took a "business barometer" reading of current economic trends, which, he said, indicate strongly that the American economy has moved onto a new and firm plateau—and will stay there.

Kentile's Torrance plant, comprising three main buildings occupying 250,000 square feet of floor area, is being built specifically to meet the growing floor covering needs of home-builders in Western states. Kentile maintains plants in Brooklyn, N. Y.; South Plainfield, N. J.; and Chicago, Ill. Occupancy of the Torrance plant is expected by January, 1960.

Kennedy said that Kentile's decision to erect a plant in Southern California was influenced by the Southland's "astounding" building upsurge.

"We learned from excellent local authority that in Los Angeles County alone construction totals during 1959 may climb to a record \$1,400,000,000 if present building trends continue," he said. "This 12-month projection is based on a building total of \$463,840,000 through April 30 of this year. It is only natural that we want to be here in California to meet the ever-increasing home building needs."

At the future Kentile plant in Torrance, California, the building will include offices for purchasing, personnel and factory supervisors; a control laboratory, occupying 4000 square feet, with up-to-date testing equipment to test raw materials and for rigid product control during manufacture; and a cafeteria.

In the manufacturing area of the same building, there will be a 50,000 square-foot mezzanine floor of reinforced concrete designed for a 250-pound per square foot live load. The manufacturing area will have a clear ceiling height of 30 feet to accommodate massive machinery.

The shipping department and warehousing building will utilize 65,000 square feet to carry a substantial inventory of the products manufactured, as well as a large supply of solid vinyl, rubber, Ken-cove vinyl wall base, Crystalite and Cork flooring also produced by Kentile.

### Area Students to Get HC Degrees

Several Torrance and Lomita students will be among the 127 graduates who will receive their Associate in Arts degrees from Harbor College today at 6 p.m.

Those from Torrance are: David Billings II, David Leroy Bitner, William Marshall Brown, Ansel R. Calloway, Eugene Donald Carriere, Manuel Ricardo Gonzalez, Donette Susan Gray, Larry Dean Napier, Richard O. Peterson, James Delbert Schaefer, Barbara Ann Taylor, William John Warner, Retha Nina Wells, Vereta Joyce Westwood and George Yoshioka.

Lomita graduates are: James Crawford Carlson Jr., Carol A. Wilson Dennis, Floyd Augustus French Jr., Carmen Jo Anne Gonzalez, Sharon Sue Gosset, Charles T. Houston, Diane Louise Kennedy, Marcia Lynn Molek, Robert Conrad Park and Stanley Charles Weiss.

**ADMITTED TO HOSPITAL**  
Reginald Darley, 4, son of Mr. and Mrs. Reginald R. Darley of 24244 Los Cotoña Ave., has been admitted as a patient at Los Angeles Orthopaedic Hospital.

### STADIUM

Daily Matinee  
Wed. Through Tues.  
1 P.M.  
Special  
Saturday Morning  
Show at 10 a.m.

### Walt Disney's 'SHAGGY DOG'

—Also—  
Van Heflin - Viveca Lindfors  
in  
'TEMPEST'

### GRAND

Phone FAirfax 8-6500  
Friday, Saturday, Sunday  
Russ Tamblyn  
in  
'TOM THUMB'  
—Also—  
Alan Ladd  
in  
'PROUD REBEL'

### HARBOR DRIVE-IN

THURS., FRI., SAT., JUNE 18-19-20  
Bob Hope - Rhonda Fleming  
'ALIAS JESSE JAMES'  
Color by Deluxe

Mickey Rooney  
'LAST MILE'

June 21-22-23  
June Allyson - Jeff Chandler  
'STRANGER IN MY ARMS'  
CinemaScope

'TANK COMMANDOS'  
With Wally Campo

### Veterinarian Meet

The May meeting of the recently organized South Bay Veterinary Auxiliary was held at the home of Mrs. William Kimball.

Plans for summer meetings were discussed, and officers for the year elected. They include Mmes. William Kimball, president; Charles Gardner, secretary; Robert Streeter, treasurer; Rollin Smith, vice president and M. L. Samuelson, publicity chairman.

### Registration Dates Bared for ECC Summer Session

Registration for summer classes at El Camino College will be held for returning students on June 29 and for new and former students on June 30, Leo M. Christian, assistant director of student personnel, announced today.

Ranging from basic mathematics and English to welding, 154 day and evening classes will be offered in the summer program. Schedules outlining courses to be presented are now available in the registration office of the college, which is located at 16007 So. Crenshaw Blvd. These may be obtained in person.

Placement tests for students enrolling for the first time in courses in English, algebra and chemistry are required. Permits for taking these tests are now available; tests will be administered by reservation only on June 23 and 24.

A three-unit course in human relation, Psychology 2, will be offered in the college curriculum for the first time. Sociology 1 and Psychology 1, which the new course will replace will be offered for the last time this summer and next fall.

An art course of special interest is Art 52, Rendering Techniques, which is basic to technical draw-

### ROADIUM drive-in theatre

REDONDO BEACH BLVD. at CRENSHAW  
Meet Jesto the Clown with His "Court of Fun!"  
Every Friday and Saturday Before the Show  
In Color

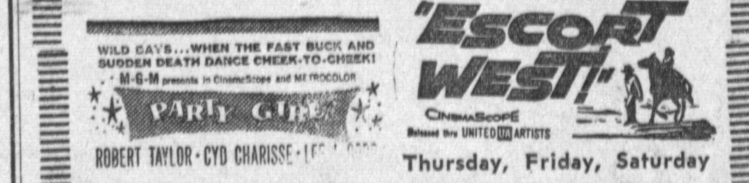

THURSDAY, FRIDAY, SATURDAY  
DAVIS 4-2664

# MOVING SALE!

It happened! We've finally had to move across the street... but our temporary quarters are far too small and we are cramped for space and we must move our stock NOW!  
**WE GUARANTEE OUR PRICES WILL NEVER BE LOWER!**

**EASY TERMS... UP TO 36 MONTHS TO PAY**

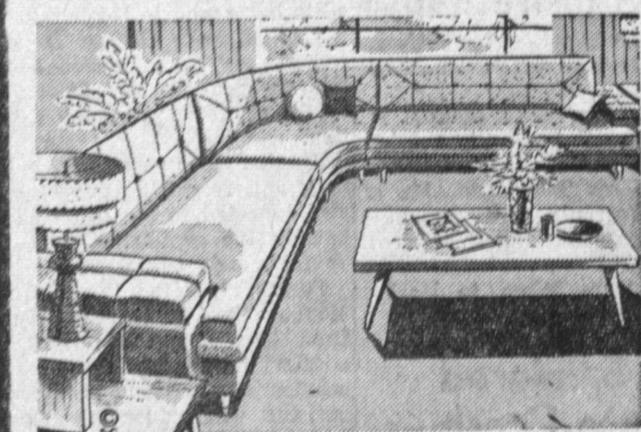

**SECTIONAL SUITE**  
**\$199<sup>95</sup>**  
3-piece, 90-deg. curved sectional. Top grade material hardwood construction. Large Ottoman to match, \$19.  
NOW ONLY



**BUNK BED GROUP**  
**\$74<sup>95</sup>**  
Bunk bed group includes two beds, two springs, two mattresses, guard rails, ladder and two bed pillows.  
ALL FOR ONLY



**LIVING ROOM SET**  
**\$119<sup>95</sup>**  
Includes Sofa and Matching Chair in various styles and colors... Three handsome tables... two table lamps in your choice of size and styles.



**Father's Day Special!**  
**59<sup>95</sup>**  
**Famous Brand RELAXER CHAIRS**  
Let Dad relax in comfort in this comfortable Vibrator Chair. Available in plastic or fabric covers.

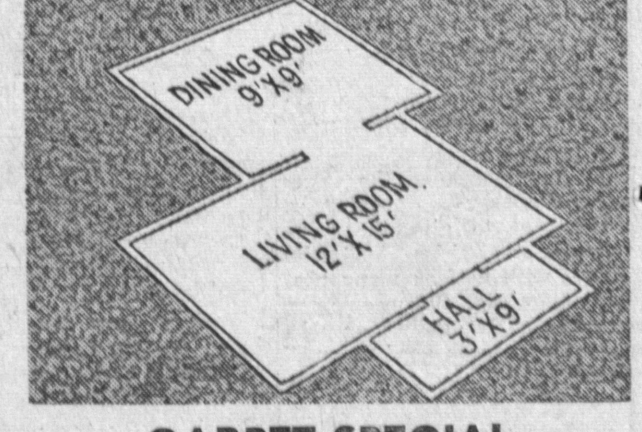

**CARPET SPECIAL**  
**\$189<sup>95</sup>**  
WE WILL INSTALL 288 SQUARE FEET OF ROADLOOM VISCOSE CARPETING, including carpet pad and tackless installation for



**COLONIAL BEDROOM SET**  
**\$99<sup>95</sup>**  
Honeytoned Salem Maple... Includes Dresser with mirror, full size Bookcase, Headboard, Box Spring and Mattress—ONLY



**MODERN DINETTE**  
**\$69<sup>95</sup>**  
Includes large 36"x48", open to 48" extension table, 6 beautiful chairs in aluminum bronze tone. (5-Pc. Dinettes Table and 4 Chairs in bronze tone, \$37.95.)



**BEDROOM SUITE**  
**\$99<sup>95</sup>**  
Includes large dresser and mirror, full-size headboard, good quality mattress and box springs and two pillows—ALL FOR

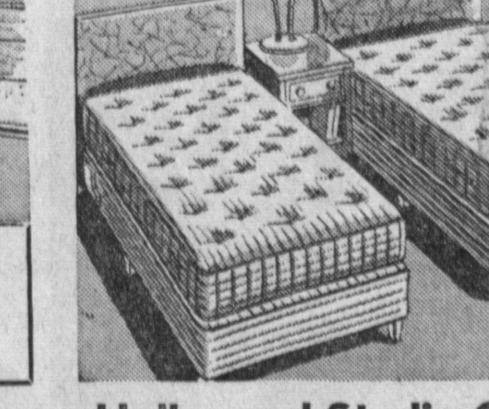

**Hollywood Studio Group**  
**\$99<sup>95</sup>**  
Included: 2 twin box springs... 2 twin mattresses... 2 plastic headboards... 2 sofa pillows—ALL FOR



**REFRIGERATOR**  
**\$199<sup>95</sup>**  
Brand New 1959 Kelvinator 10 1/2 Cu. Ft. 30-lb. freezer, shelves in door, butterkeeper, large pull-out storage bin. Res. \$259.95. Limited.

**SAVE \$12.00**  
**COTTON 9 x 12 RUGS**  
WERE \$29 — NOW ONLY  
**\$17<sup>00</sup>**

**Torrance FURNITURE**  
*We Make Your House a Home*

**Bargain Annex No. 2**  
1266 Sartori Ave. Downtown Torrance  
Across the Street from Our Old Location  
**PHONE FA 8-5550**  
Open Friday and Monday Nights 'til 9 p.m.