



CELEBRATING ANNIVERSARY... One of the biggest sales in the history of the Thriftmart chain will be presented during the period of Oct. 30 through Nov. 12 in celebration of the company's 31st anniversary, it was announced yesterday by President Roger M. Lavery Sr. The chain was originally incorporated under the name of Fitzsimmons Stores, Ltd., in September 1930. Today, in addition to the 62 Thriftmarts, the company owns and operates a wholesale grocery division, a meat packing plant, delicatessen kitchen, a realty corporation and a finance company. In addition, the company owns a partnership interest in the Jersey Milk Products Co.

Lomita Street Project Voted

Allocation of \$1,600 for the improvement of 250th Street at the Pennsylvania Avenue intersection in Lomita was announced yesterday by Supervisor Burton W. Chace.

Work will be scheduled by the Los Angeles County Road Dept. pending completion of other portions of the current work load, he said.

The improvement will consist of extending the pavement to join recently constructed curb and gutter. In addition, a cross-gutter will be constructed across 250th Street on the west side of Pennsylvania Avenue.

"This roadway improvement project is one phase of work performed by the County Road Dept. in cooperation with property owners who constructed the curb and gutter under permit," Chace said.

Roadway benefits to be derived from the proposed project will be the improvement of drainage conditions, the reduction in maintenance costs, and increased operational efficiency.

Larry Ward New DANCE CLASSES Now Starting

ADULT'S BEGINNERS SQUARE DANCE CLASSES

Starts Oct. 18th and 25th — 8:30 p.m.

CHILDREN'S BEGINNERS SQUARE DANCE CLASSES

Start Oct. 19th and 26th — 6:00 p.m. — Ages 8-15

PRE-TEENS BALLROOM CLASSES

Start Oct. 24th — 6:00 p.m.

JUNIOR TEEN BALLROOM CLASSES

Start Oct. 17th and Nov. 7th — 6:00 p.m.

All Classes Will Be Instructed By Larry Ward and Will Be Held At

**WARD'S HALL • 185 N. Hawthorne Blvd.
HAWTHORNE**

PHONE OS 5-9606—For Further Information

OFFICE HOURS: 3 p.m. to 11 p.m.

Pepperdine College Dean Continuing Sermon Series

"Continuing through its fifth day, the Redondo Beach Church of Christ lecture series, has been well received by both members of the church and our neighbors in the community," Dr. Warren S. Jones, minister, announced yesterday.

This lecture series titled "What is Truth" has presented Dr. J. P. Sanders, Dean of George Pepperdine College, minister, and well-known educator.

"WE BELIEVE the church could serve the community in which it exists," Dr. Jones said, "and one of the purposes of this lecture series is to acquaint the community with the Redondo Beach Church of Christ. The presence of so many of our friends and neighbors at this series has been very rewarding," Dr. Jones continued, "and shows a strong interest in New Testament Christianity and man's eternal search for truth."

Dean Sanders, co-founder

and former editor of the "20th Century Christian," a widely circulated Christian magazine, is being presented each evening at 7:30. He is also speaking Sunday morning at the 10:45 worship service.

DURING THE Christ-centered lecture series, Dr. Sanders has presented interesting and enlightening sermons on such topics as "Christian Faith and Modern Knowledge," "The Reality of God and Human Experience," "The Cross — God's Revelation of Truth," as well as other timely subjects.

The public is cordially invited to attend the remaining services of the lecture series each evening at 7:30, Sunday morning at 10:45, and all other services of the church.

FOR THE BEST
CLASSIFIED RESULTS

FA 8-4000

Health Officer Plans Class for Mothers-to-Be

Classes for mothers-to-be will start Thursday, Oct. 26, at 1 p.m. in the Torrance Health Center, 2300 W. Carson St., according to Dr. B. A. Kogan, district health officer for the Los Angeles County Health Department.

Hygiene of pregnancy, labor, childbirth and care of the newborn are some of the topics to be discussed by Mrs. J. Mendoza, public health nurse-instructor. Films and demonstrations will be used throughout the seven-session series.

The expectant parents classes are planned for the patients of private physicians. Continued attendance to the class is determined by the physician's consent. The classes supplement the teachings of the family physician and in no way do they take the place of early and adequate prenatal care.



FAMILY DENTAL SERVICE

NO MONEY DOWN — 18 MONTHS TO PAY

Pensioners & Public Assistance Cases Welcome

IMMEDIATE DENTURES **PLATES** EXTRACTIONS
FILLINGS **X-RAY**
EXTRACTIONS WITH SLEEP BY ARRANGEMENT

DR. FREEMAN
CREDIT DENTIST

SERVING THE ENTIRE SOUTH BAY AREA
4537 Redondo Beach Blvd. Lawndale
DIRECTLY OPPOSITE SOUTH BAY CENTER

OPEN DAILY
SATURDAYS
and EVENINGS
No Appointment
Necessary
PHONE:
370-2588

EASY CREDIT
LOW PRICES

QUICK PLATE
REPAIRS
and RELINES

NEW AIR DRILL

OPEN TODAY, THURSDAY - 9 A.M. to 9 P.M.

CARPET TOWN'S 3-Room Carpet Sale!

40 SQ. YD. SALE! — 50% Wool — 50% Nylon HI-LO
Carpet Your Living Room, Dining Room, Hallway at These Low, Low Prices!

FIRST QUALITY

50% WOOL — 50% NYLON

Here's the best carpet value in the low price field! Ideal wall-to-wall carpeting for the budget minded and value conscious homemaker! Easy to clean, good looking popcorn Hi-Lo pattern, in a choice of tweeds and solids.

3 Rooms — 40 Sq. Yds.

NOTHING
ELSE TO
PAY FOR

\$199

Completely Installed
Over Heavy Foam Padding
EASY BANK TERMS

**COMPLETELY
INSTALLED**
(40 sq. yd. Basis)

AT THESE PRICES

INCLUDING:
• Heavy Foam Rubber Padding
• Invisible Tackless Installation
• All Door Metals

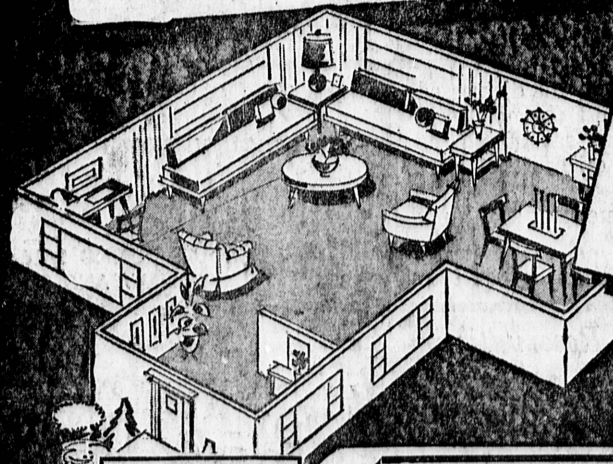

PHONE NOW
FR 5-0518



EARLY AMERICAN
ROOM SIZE OVAL
BRAIDED RUGS

SAVE ON THESE OTHER SIZES

• 2x3-ft. \$3	• 6x9-ft. \$19
• 2x4-ft. \$4	• 8x10-ft. \$29
• 3x5-ft. \$6	• 10x14-ft. \$49
• 4x6-ft. \$9	• 11x15-ft. \$59

ASST. COLOR MIXES
NEW ENGLAND PATTERNS

WOOL

9 x 12 FOOT SIZE
* APPROX. SIZES

\$39

Carpet Town
The West's Largest Low Price Carpeting Stores
Choose from our 250 Full Roll Stock
to be sure of Quality and Color!

DEL AMO CENTER ANNEX

3822

**SEPULVEDA BLVD.
TORRANCE**

Across From Sears and the Broadway
at Hawthorne Blvd.

OPEN—WEEKDAYS 9 a.m. to 9 p.m.
SUNDAYS 10 a.m. to 5 p.m.; SATURDAY 9 a.m. to 6 p.m.