

if you work

—in any of the following plants in the Torrance district:

- ALCOA
- B & R MACHINE WORKS
- BOHN ALUMINUM & BRASS CO.
- COAST MANUFACTURING CO.
- COLUMBIA STEEL CO.
- D & M MACHINE WORKS
- DICALITE COMPANY
- DOAK AIRCRAFT CO., INC.
- DOW CHEMICAL CO.
- FELKER MANUFACTURING CO.
- GENERAL PETROLEUM CORP.
- GOODYEAR RUBBER RESERVE
- INTERNATIONAL DERRICK
- JOSHUA HENDY IRON WORKS

- KELLOG CONSTRUCTION CO.
- LONGREN AIRCRAFT CO.
- MARTIN TOOL & DIE WORKS
- NATIONAL SUPPLY CO.
- PACIFIC FORGE
- PACIFIC SMELTING
- RUBBERCRAFT CORPORATION
- SHELL CHEMICAL CO.
- SOULE STEEL CO.
- SO. CALIFORNIA TELEPHONE CO.
- STAUFFER CHEMICAL CO.
- TORRANCE ALUMINUM PROD.
- TORRANCE BRASS FOUNDRY
- TORRANCE PRECISION MFG.
- TORRANCE STEEL
- UNITED STATES RUBBER CO.

—or a Civilian Employee of the United States Government

You May Be Eligible

TO BUY OR TO RENT A

New Home

--- IN ---



—in the vicinity of Carson St.
Between Normandie and
Western

See Map
BELOW

Walking Distance to Torrance Shopping District and Many
War Production Plants

\$4650 House and Lot Complete **\$5250**
(2 Bedrooms) **FHA APPROVED** (3 Bedrooms)
Sewers - Sidewalks - Paved Streets - Lawns - Shrubs
Included!

AS LOW AS ONLY **\$290 DOWN** PLUS FHA CHARGES AND IMPOUNDS
\$40.00 MONTHLY RENTAL \$42.50

RESERVATIONS NOW!

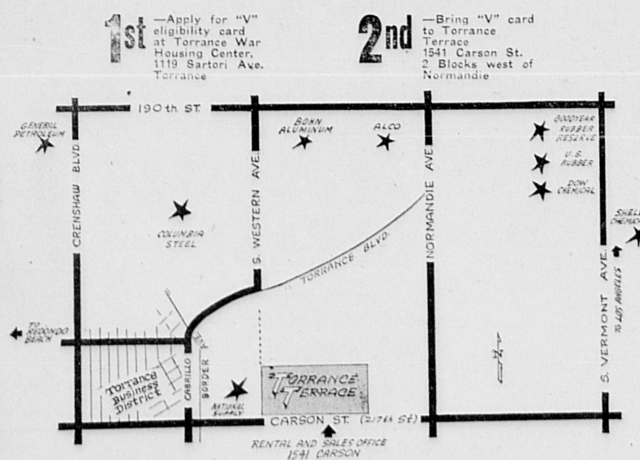

DRIVE —South of Torrance Business District to CARSON STREET, then east a few blocks . . . or drive on Vermont or Normandie Ave., then west on Carson a few blocks to Torrance Terrace

OFFICE —1541 Carson St. . . . Torrance

Open Daily and Sunday Till Sold or Reserved!

OBITUARY

CHARLES SCRIFE—Aged 60, of 1245 West Fifth st., Manhattan Beach, met death over the weekend by being crushed under a dump truck at the Coast Insulating plant in Torrance. He was a member of the Eagles, Eyrle at Long Beach. Funeral services were held yesterday, Wednesday, Dec. 22, at the Stone & Myers chapel at 2 p.m. under auspices of the Eagles. Private cremation followed at the Pacific Crest cemetery. Survivors are: his wife, Eleanor A. Scrife of the above mentioned address; sister-in-law, Mrs. Susan Lawson, 1967 Morego ave., Pasadena, and a brother, Donald M. Scrife, 5917 Holmes ave., Los Angeles.

BLANCHE OEFA STANFIELD—Age 62 of 2621 West 158th st., Gardena, passed away at her home after a lingering illness. Funeral services were held Dec. 21 at 2 p.m. in the Stone & Myers chapel, conducted by Rev. William Dennis of the Full Gospel church. Interment followed at Forest Lawn cemetery, Glendale. Mrs. Stanfield is survived by four sons, Laveigh, Los Angeles; Guy, Alberta, Canada; Harry H., 2621 West 158th st., and Alvin, Portland, Ore. Also by her mother, Mrs. Margaret E. Storrs, Winter-set, Iowa, and four brothers in Iowa.

VERA BELLE PORTER—Age 22, victim of suicide at 2048 Sepulveda blvd., Dec. 15. The body was shipped by the Stone & Myers mortuary to Corona N.M., for interment. The deceased is survived by her husband, Charles C. Porter, 880 Avenue A, Redondo Beach; her father, Albert L. Jones, Alamogordo, N.M.; an uncle and aunt, Mr. and Mrs. Elmo R. Slaek, 1138 Maple st., Torrance; uncle and aunt Mr. and Mrs. A. B. Lane, 2048 West Sepulveda blvd., Torrance.

Hospital Cases

Following is a list of patients in hospital from the Torrance and Lomita areas during the past week:

- Mrs. Dorothy Banks, 1621 Beech ave., Torrance.
- E. Hatwood Clark, 2562 Torrance blvd., Torrance.
- Mrs. Ruth Hunter, 1535 Marce-

STORKatorials

Torrance Memorial hospital: Mr. and Mrs. Joe Banks, 1621 Beech ave., Torrance, a boy, Dec. 12.

Mr. and Mrs. Robert C. Hunter, 1535 Marcelina ave., Torrance, a girl, Dec. 17.

Mr. and Mrs. George Pratt, 1323 Fern ave., Torrance, a boy, Dec. 19.

Mr. and Mrs. Albert Trahan, 2313 241st st., Lomita, a girl, Dec. 19.

Seaside hospital: Mr. and Mrs. D. H. Calkins, Lomita, a son, Dec. 8.

BUILDING PERMITS

Building permits issued from the Torrance city engineer's office this week included the following:

- C. R. Jones, 1747 Andreo ave., garage bldg., \$250.
- Charles J. Earnst, 1023 Madrid ave., two-car frame garage, \$250.

Townsend Club No. 2

By M. E. ATTEBERY

Election of officers and other important business was transacted last Thursday evening when members of Torrance Townsend club No. 2 met at Men's Bible Class bldg. Mrs. M. E. Aattebery was unanimously elected to serve as the organization's president during the ensuing term.

A Christmas party has been planned for Thursday, Dec. 23, with a decorated tree and gifts for everyone. Refreshments will be served and Fiddler Jack Rich will furnish music for dancing.

INDIANA DATA

The average Indiana motorist in 1942 drove 8410 miles and used about 497 gallons of gasoline for an average of 17 miles to the gallon, according to statistics recently revealed. For driving, exclusive of out-of-state travel, Hoosier motorists used 388,703,000 gallons of gasoline.

- lina ave., Torrance.
- Bobby Mannis, 24316 Eshelman ave., Lomita.
- Sara C. Murray, 1514 Amapola ave., Torrance.
- Mrs. Marion Pratt, 1323 Fern ave., Torrance.
- Mrs. Mildred Trahan, 2313 241st st., Lomita.



MUTINY

that's what it is!!

We rebel! We're doggoned if we're going to say "Merry Christmas to our friends and customers again this year. We've said the same thing so many times, seems like we gotta say something different. We've got it! This year, we're simply gonna say, "The same to you!"

WE WILL BE CLOSED
FRIDAY & SATURDAY
Dec. 24th - 25th

The House of Good Food
DANIELS CAFE
1625 Cabrillo

Warden Clyde Plummer's Resignation Accepted

The State Board of Prison directors met in Los Angeles Friday and accepted the resignation of Clyde Plummer, warden of Folsom prison.

The board met earlier at Chicago but with the absence of Judge Pacht, confined to bed with influenza, and of Members Julian Alco and Dr. W. Earle Smith, it was found to be without a quorum. Later in the day Members Henry Craemer and George Briggs met with Judge Pacht at his Santa Monica home.

Plummer's resignation had been submitted earlier this month following an investigation of the prison conditions by a committee appointed by Gov. Warren.

Licensed to Wed

Licenses to wed were issued by the county clerk this week to persons known in this area: Leonard R. Cross, 39, U.S. Army; Gladys V. Richardson, 33, Torrance; Johnny Rafanan, 34, Stockton; Aurora Theresa Zagal, 17, Lomita.

May Your Christmas Be Merry,
and May Happiness Follow You
Throughout the New Year

Because we've so greatly enjoyed our relationship with you during the past year, we hope that 1944 will find you getting the utmost in joy from your daily contacts with your fellow men.

STAR FURNITURE CO

1255 Sartori Ave., Torrance

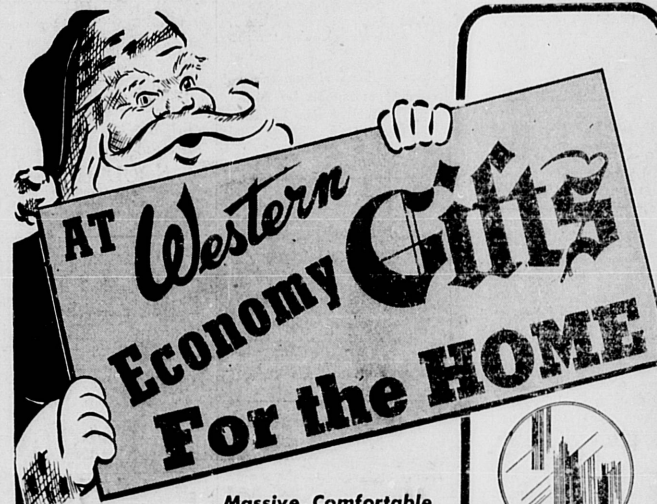

... Massive, Comfortable PLATFORM ROCKER



\$39.95
Easy Terms

An attractive, restful smooth-action rocker with deep padded seat and back . . . built to give years of service . . . all exposed wooden parts finished in walnut or maple color and richly carved . . . coverings are of durable assorted materials and patterns. GM2189

Glass Top Cocktail Table



\$10.50

A graceful new ripple edge table in rich walnut color with full-size glass top . . . well constructed throughout. An attractive, useful piece of furniture for the home. G2023

Attractive Mahogany Table

With Glass Top

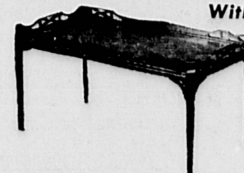

\$10.95

This table has a mahogany top which is protected with a full-size glass cover, held in position by a richly carved safety railing. Excellent construction in every detail. Size 17x33 inches. G9022

ALL MERCHANDISE SUBJECT TO STOCK ON HAND

Western Auto Stores

1273 Sartori

Phone Torrance 265



24" Plate Glass
MIRROR
Ceiling Price \$5.95
\$6.95

A flawless, genuine plate glass circle mirror . . . adds depth and sparkle to your room's dimensions. G5941

CHARMING PICTURES

Artistic etchings and clever figure drawings in modern frames with dust-proof backs. G661

12x16-inch FLORALS—Beautiful flower arrangements in their true-to-life coloring . . . attractively framed, under clear glass with dust-proof backs. G666

ENCHANTING FLORALS 22x28 inches. Flower groupings with warm, artistic backgrounds . . . framed in carved gold and antique white. G6652



24x45" Chenille
THROW RUG
Guaranteed fast color in dusty rose, blue, lime and Nile green, reversible with white back and fringed ends. GS201-4

24x45-inch size in the same quality and the same colors. GS205-8

Oval shape 30x38 inches, new type Chenille . . . with a fringed edge all around . . . Rose, blue, peach, green. GS215-18