

Contractors-General-(Cont'd)

CASE CONSTRUCTION CO

GUNITE
 MARINE CONSTRUCTION
 DREDGING - DERRICKS
 BARGES - TOWING
 Long Beach Phone 7-4187
 Nevada 6-1791
 2100 Wilmington & San Pedro Rd
 San Pedro, TErmini 2-4591

Case Construction Co

2100 Willingmtn & Sn Pedro Rd SnPed, TErmini 2-4591
 Cope Stephen M 307 N Avaln Bl Wilm, TErmini 4-1052

Coy Construction Co

Grading & Excavating Contractor
 1734 Pac Coast Hwy, Lomita-108
Crawford C G Building Contractor

831 S Walkr Av SnPed, TErmini 3-0172
Custom Bilt Homes 1620 E Robidoux Wilm, TErmini 4-4728

DENNI INVESTMENT CORP

Gic 736 N Avaln Bl Wilm, TErmini 4-6401
 Tractor Yard 22610 S Main Wilm, TErmini 4-2112
 (See Advertisement This Page)

F & M CONSTRUCTION CO

2013 Pacific Coast Hwy, Lomita-1485
 (See Advertisement This Page)
Fletcher A L 827 20th SnPed, TErmini 3-2111

GALLINGER CONSTRUCTION CO

418 S Gaffy SnPed, TErmini 3-3442
 Gonzales Andrew 1031 W Sepulveda SnPed, TErmini 2-1082
 Gonzales Chas 1619 Lakme Av Wilm, TErmini 4-2275

GOZALES CONSTRUCTION CO

See Our Ad under Contractors-Building
 119 W 7th SnPed, TErmini 3-3876
Hansen Don K 1343 254th HarCty, Lomita-1621-W

Hedde H W Co Mlnr SnPed, TErmini 2-5343
HOMESTEAD BUILDERS 460 18th SnPed, TErmini 3-3708
 (See Advertisement Following Page)

Keith & Keith Building Contractors

24814 Narbonne Av, Lomita-167
Macco-Case Construction Co 407 W 7th SnPed, TErmini 3-2526
Marich Sam K 825 Miraflores Av SnPed, TErmini 2-2318
Marich Sam K 1224 S Pacific Av SnPed, TErmini 3-0405

(Continued on Next Page)

NOLAN BROS. GENERAL CONSTRUCTION COMPANY

202 W. 7th St. • SAN PEDRO

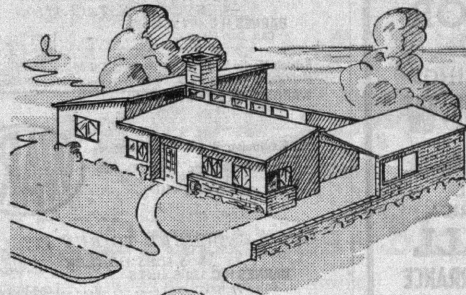

**RESIDENTIAL
 COMMERCIAL**

Architectural
 & Engineering
 Services Available

Call

**TErmini
 2-6060**

Consult the Yellow Pages before buying.
 It's one of the quickest ways to locate a
 local source of supply.

GENERAL CONTRACTING

- BUILDING
- ALTERATIONS
- ADDITIONS
- PAINTING
- COMMERCIAL
- RESIDENTIAL

Lomita 915
Robert J. Ross
 1649 252nd STREET

F & M Construction Co.

GENERAL CONTRACTORS

- BUILDERS
- DEVELOPERS
- DESIGNERS
- REMODELING

for
 HOMES & COMMERCIAL BUILDING

Phone

**LOMITA
 1485**

**2013 Pacific Coast Hwy.
 101 HIGHWAY**

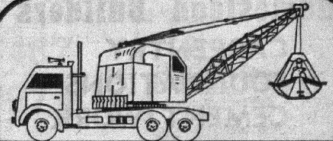

GENERAL EXCAVATING CONTRACTOR

SHOVELS - CARRYALLS
 TRUCK CRANES - CRAWLER CRANES
 TRACTORS - BULLDOZERS

YARD - 22610 S. MAIN - WILMINGTON
 OFFICE - 736 N. AVALON - WILMINGTON

TErmini 4-6401
 If No Answer Call TErmini 4-2112

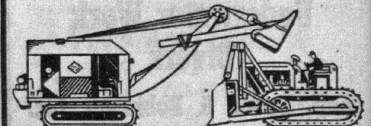

DENNI INVESTMENT CORP.